

1.1. FRONT BEARING AND AXLE KIT FOR THE CROSSMAX™ SL AND SPEEDCITY™ WHEELS

Tools needed:

- 1 x 5 mm Allen wrench
- 1 hub wrench M40123
- Bearing pullers M40120 (Crossmax™ SL) or M40373 (Speedcity™)

- 1 Remove the fork support on the adjustment nut side. This is press fit on the end of the axle.
- 2 Insert a 5 mm Allen wrench on the opposite side of the adjustment nut and loosen the adjustment nut using the hub wrench M40123.
- 3 Remove the axle.
- 4 Drive out the bearings with the bearing pullers M40120 (long rod, see photo page 40) ;
- 5 Mount the new bearings using the bearing pullers M40120 (Crossmax™ SL) or M40373 (Speedcity™) ;
- 6 Mount the axle: insert the 5 mm Allen wrench in the axle and tighten the adjustment nut using the hub wrench M40123.
- 7 Clip the fork support back on ;
- 8 Put the wheel back in place on the fork, tighten the quick release skewer and adjust the bearing free play using the hub wrench M40123.

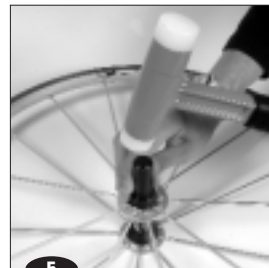
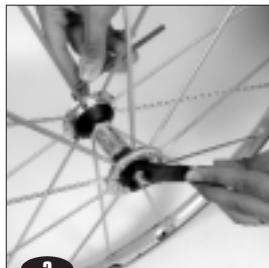

For the front Crossmax™ SL wheel, NEVER replace the bearings on a bare hub. Always replace them when the hub is built into a wheel.